



Circuit Protection

Domestic Fuses	196
Industrial Fuses	197-200
Domestic Circuit Protection	201-204
RCBOs/MCBs/RCDs	205
RCD Enclosures/Isolator Switches	206
Control Devices	207

DOMESTIC FUSES

FUSES - BS 646



- For use in wall and stand alone shaver adaptors, dimming switches and plug top night lights with an integral light.
- Colour coded to identify rating.
- Voltage 250V.
- Breaking capacity 1000A.

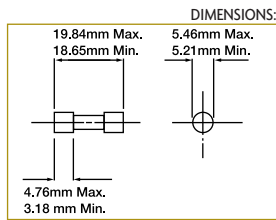

ORDER CODE	MODEL NO.	RATING (Amps)	COLOUR	PRICE - EA
				1 off
1050152908	NLF601	1	Green	£1.17
1050152909	NLF602	2	Yellow	£1.17
1050152910	NLF630	3	Black	£1.17
1050152911	NLF600	5	Red	£1.17



FUSES - BS 1362 PLUG TOP



- Suitable for 13A plug tops.
- 6.4mm dia x 25.4mm length.
- Voltage 240V.
- ASTA certified and tested in accordance with BS 1362.
- Pack of 10.



ORDER CODE	MODEL NO.	RATING (Amps)	PRICE - PK
			1 off
1050152901	NLF1	1	£2.95
1000015794	NLF2	2	£2.95
1000015795	NLF3	3	£2.95
1000015796	NLF5	5	£2.95
1050152902	NLF7	7	£2.95
1000015797	NLF10	10	£2.95
1000015822	NLF13	13	£2.95



FUSES - BS 1361 CONSUMER UNIT



- 240V AC rated voltage.
- Approved for the protection of outgoing circuits in domestic consumer units.
- Supplied individually.



ORDER CODE	MODEL NO.	RATING (Amps)	COLOUR	DIMENSIONS (mm)		PRICE - EA
				DIA.	LENGTH	1 off
1050152903	NLCUF5	5	White	5.35	23	£1.24
1050152904	NLCUF15	15	Blue	10.32	26	£2.41
1050152905	NLCUF20	20	Yellow	10.32	26	£2.00
1050152906	NLCUF30	30	Red	12.70	29	£2.41
1050152907	NLCUF45	45	Green	16.67	35	£7.25



FUSES - BS 1361 HOUSE SERVICE CUT OUT



- 415V AC rated voltage.
- Designed for use in conventional house cut-outs.
- ASTA certified and tested in accordance with BS 1361.
- Supplied individually.

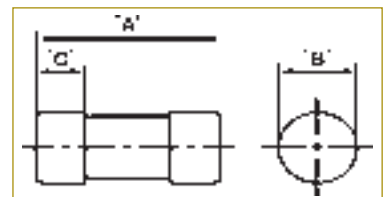

ORDER CODE	MODEL NO.	RATING (Amps)	DIMENSIONS (mm)			PRICE - EA
			A	B	C	1 off
1050152899	NL60KR85	60	57.0	22.2	16.0	£8.60
1050152900	NL80KR85	80	57.0	22.2	16.0	£9.62

NB: Check suitability of fuse holders before inserting these fuse links.

All prices subject to VAT at 17.5%.

FUSES - BS 88 CARTRIDGE

- A range of industrial and commercial fuses for use in a wide range of applications.
- High Rupturing Capacity (HRC) with bolted connections are for use in industrial and commercial installations and may be fitted in fuse units or fuse gear.
- Two hole fixing.
- Breaking Capacity 80kA at 415V AC.
- The fuse-links comply with the revised standard BS 88: Part 2: IEC 60269 Part 2 specifying characteristics for fuse links for use by authorised persons (mainly for industrial applications) and additional requirements for fuse links with bolted connections.
- Supplied in packs of 3.

FUSES - BS 88 CARTRIDGE NITD TYPE



- Industrial HRC fuse links - type A1.
- Offset bolted tags 550V AC.
- 415V AC for motor rated fuse links.
- BS 88: Parts 1 + 2 1988.
- IEC 269-1 1986.
- Pack of 3.

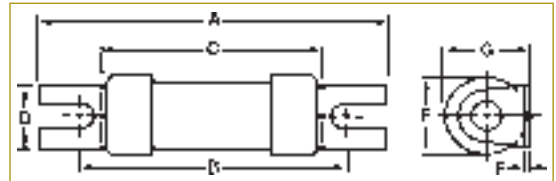

ORDER CODE	MODEL NO.	RATING (AMPS)	RATING	DIMENSIONS (mm)								PRICE - EA 1 off
				A	B	C	D	E	F	G		
1050152875	NLNITD2	2	550V AC	55.0	44.5	34.6	11.2	13.8	0.8	14.0	£10.06	
1050152876	NLNITD4	4	550V AC	55.0	44.5	34.6	11.2	13.8	0.8	14.0	£10.06	
1050152877	NLNITD6	6	550V AC	55.0	44.5	34.6	11.2	13.8	0.8	14.0	£10.06	
1050152878	NLNITD10	10	550V AC	55.0	44.5	34.6	11.2	13.8	0.8	14.0	£10.06	
1050152879	NLNITD16	16	550V AC	55.0	44.5	34.6	11.2	13.8	0.8	14.0	£10.06	
1050152880	NLNITD20	20	550V AC	55.0	44.5	34.6	11.2	13.8	0.8	14.0	£11.08	
1050152881	NLNITD25	25	550V AC	55.0	44.5	34.6	11.2	13.8	0.8	14.0	£12.21	
1050152882	NLNITD32	32	550V AC	55.0	44.5	34.6	11.2	13.8	0.8	14.0	£12.21	
1050152896	NLNITD20M32	20 - MR32	415V AC	55.0	44.5	35.6	11.2	17.5	1.2	18.5	£12.42	



FUSES - BS 88 CARTRIDGE AAO TYPE



- Industrial HRC fuse links - type A2.
- Offset bolted tags 550V AC.
- 550V AC rated voltage.
- BS 88: Parts 1 + 2 1988.
- IEC 269-1 1986.
- Pack of 3.

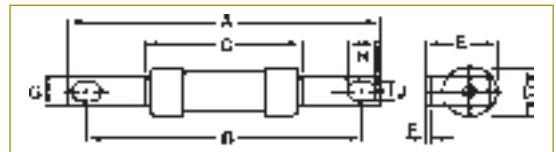

ORDER CODE	MODEL NO.	RATING (AMPS)	DIMENSIONS (mm)										PRICE - PK 1 off
			A	B	C	D	E	F	G	H	J		
1050152883	NLAAO2	2	85.0	73.5	35.5	13.7	14.0	1.2	8.7	8.0	5.5	£15.12	
1050152884	NLAAO4	4	85.0	73.5	35.5	13.7	14.0	1.2	8.7	8.0	5.5	£15.35	
1050152885	NLAAO6	6	85.0	73.5	35.5	13.7	14.0	1.2	8.7	8.0	5.5	£15.35	
1050152886	NLAAO10	10	85.0	73.5	35.5	13.7	14.0	1.2	8.7	8.0	5.5	£14.90	
1050152887	NLAAO16	16	85.0	73.5	35.5	13.7	14.0	1.2	8.7	8.0	5.5	£16.32	
1050152888	NLAAO20	20	85.0	73.5	35.5	13.7	14.0	1.2	8.7	8.0	5.5	£16.32	
1050152889	NLAAO25	25	85.0	73.5	35.5	13.7	14.0	1.2	8.7	8.0	5.5	£16.53	
1050152890	NLAAO32	32	85.0	73.5	35.5	13.7	14.0	1.2	8.7	8.0	5.5	£16.53	
1050152897	NLAAO32M40	32 MR40	85.0	73.5	54.5	21.0	22.3	1.2	8.7	8.0	5.5	£19.99	



All prices subject to VAT at 17.5%.

INDUSTRIAL FUSES

FUSES - BS 88 CARTRIDGE BAO TYPE



- Industrial HRC fuse links - type A3.
- 550V AC rated voltage.
- Offset bolted tags 550V AC.
- BS 88: Parts 1 + 2 1988.
- IEC 269-1 1986.



- Pack of 3.

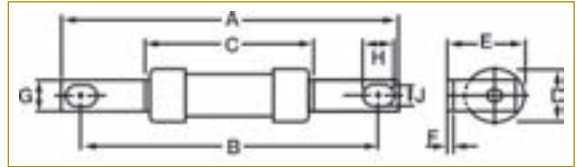

ORDER CODE	MODEL NO.	RATING (Amps)	DIMENSIONS (mm)									PRICE - PK	
			A	B	C	D	E	F	G	H	J	1 off	
1050152891	NLBAO40	40	87.0	73.5	54.5	21.0	22.5	1.2	12.7	8.0	5.5	£26.65	
1050152892	NLBAO50	50	87.0	73.5	54.5	21.0	22.5	1.2	12.7	8.0	5.5	£26.65	
1050152893	NLBAO63	63	87.0	73.5	54.5	21.0	22.5	1.2	12.7	8.0	5.5	£26.65	
1050152898	NLBAO63M100	63 - MR100	87.0	73.5	54.5	21.0	22.5	1.2	12.7	8.0	5.5	£43.86	

FUSES - BS 88 CARTRIDGE CEO TYPE



- Industrial HRC fuse links - type A4.
- 550V AC rated voltage.
- Offset bolted tags 550V AC.
- BS 88: Parts 1 + 2 1988.
- IEC 269-1 1986.



- Pack of 3.

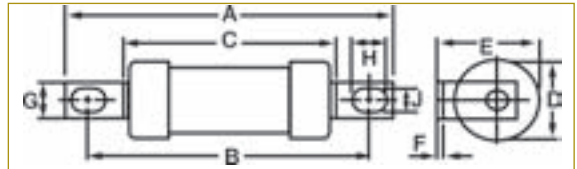

ORDER CODE	MODEL NO.	RATING (Amps)	DIMENSIONS (mm)									PRICE - PK	
			A	B	C	D	E	F	G	H	J	1 off	
1050152894	NLCEO80	80	110	94.0	58.5	21.0	24.5	3.2	14.3	11.0	8.7	£43.86	
1050152895	NLCEO100	100	110	94.0	58.5	21.0	24.5	3.2	14.3	11.0	8.7	£43.86	

FUSES - MINIATURE GLASS SLOW BLOW 20mm x 5mm

ORDER CODE	MODEL NO.	RATING (Amps)	PRICE - EA
			1 off
1050064025	NLGM5SB	100mA	£0.64
1050066458	NLGM6SB	125mA	£0.64
1050068677	NLGM8SB	160mA	£0.64
1050063066	NLGM10SB	250mA	£0.59
1050068678	NLGM11SB	315mA	£0.76
1050063067	NLGM13SB	500mA	£0.59
1050068679	NLGM17SB	800mA	£0.59
1050063068	NLGM18SB	1	£0.59
1050068680	NLGM19SB	1.25	£0.59
1050215075	NLGM21SB	1.6	£0.59
1050215076	NLGM22SB	2	£0.59
1050068682	NLGM23SB	2.5	£0.59
1050063070	NLGM25SB	3.15	£0.59
1050068683	NLGM26SB	4	£0.59
1050063071	NLGM27SB	5	£0.59
1050063072	NLGM28SB	6.3	£0.59
1050063073	NLGM31SB	8	£0.59
1050063074	NLGM32SB	10	£0.59

FUSES - MINIATURE



- A range of miniature glass and ceramic fuses.
- 250V.

FUSES - MINIATURE GLASS SLOW BLOW 1 1/4" x 1 1/4"

ORDER CODE	MODEL NO.	RATING (Amps)	PRICE - EA
			1 off
1050068687	NLGF13SB	500mA	£1.05
1050063088	NLGF18SB	1	£0.69
1050063089	NLGF22SB	2	£1.05
1050063090	NLGF24SB	3	£1.05
1050068688	NLGF26SB	4	£1.05
1050063091	NLGF27SB	5	£1.05
1050063093	NLGF31SB	8	£0.84
1050063094	NLGF32SB	10	£0.84
1050066459	NLGF33SB	12.5	£0.70



All prices subject to VAT at 17.5%.

FUSE CARRIER



- A single pole carrier, suitable for holding 10 x 38mm fuses.
- Rated 32A and 690V.
- Fits standard 35mm top hat rail.
- UL and CSA approved.
- Colour: Grey.

➡➡➡ For Top Hat Rail see page 290.



ORDER CODE	MODEL NO.	PRICE - EA
		1 off
1050063185	NLFCFH10	£8.18

FUSES - IEC CYLINDRICAL (FRENCH INDUSTRIAL)



- Available in two types:
gG/gL = General purpose e.g. resistive loads.
aM = Motor rated, suitable for motor or similar inductive loads.
- All fuses rated 500V.
- Dimensions 10 x 38mm.
- Silver plated contacts allow improved contact and corrosion resistance.
- Ceramic body provides greater resistance to thermal shock and internal pressure.
- Manufactured to IEC 269 1-2 and 269 2-1 and NFC 63210.

FUSES - CYLINDRICAL GENERAL PURPOSE

- Type gG/gL.

ORDER CODE	MODEL NO.	RATING (Amps)	PRICE - EA
			1 off
1050063164	NLGG1002	2	£1.06
1050063165	NLGG1004	4	£1.06
1050063166	NLGG1006	6	£1.06
1050063168	NLGG1010	10	£1.10
1050063170	NLGG1016	16	£1.10
1050063171	NLGG1020	20	£1.53
1050063172	NLGG1025	25	£1.54
1050063173	NLGG1032	32	£1.20

NB: These fuses are without an indicator



FUSES - CYLINDRICAL MOTOR RATED

- Type aM.

ORDER CODE	MODEL NO.	RATING (Amps)	PRICE - EA
			1 off
1050063174	NLAMI002	2	£1.33
1050063175	NLAMI004	4	£1.30
1050063176	NLAMI006	6	£1.30
1050063178	NLAMI010	10	£1.30
1050063180	NLAMI016	16	£1.30
1050063181	NLAMI020	20	£1.40
1050063182	NLAMI025	25	£1.40
1050063183	NLAMI032	32	£1.62

NB: These fuses are without an indicator



INDUSTRIAL FUSES

FUSES - MINIATURE GLASS QUICK BLOW 20mm x 5mm



ORDER CODE	MODEL NO.	RATING (Amps)	PRICE - EA 1 off
1050063057	NLGM5QB	100mA	£0.58
1050066457	NLGM6QB	125mA	£0.58
1050068363	NLGM10QB	250mA	£0.53
1050068364	NLGM11QB	315mA	£0.53
1050063058	NLGM13QB	500mA	£0.58
1050068676	NLGM17QB	800mA	£0.58
1050063059	NLGM18QB	1	£0.58
1050068366	NLGM19QB	1.25	£0.58
1050068367	NLGM21QB	1.6	£0.58
1050063060	NLGM22QB	2	£0.58
1050068368	NLGM23QB	2.5	£0.58
1050063061	NLGM25QB	3.15	£0.58
1050068369	NLGM26QB	4	£0.58
1050063062	NLGM27QB	5	£0.58
1050063063	NLGM28QB	6.3	£0.58
1050063064	NLGM31QB	8	£0.58
1050063065	NLGM32QB	10	£0.58



FUSES - MINIATURE GLASS QUICK BLOW 1 1/4" x 1/4"



ORDER CODE	MODEL NO.	RATING (Amps)	PRICE - EA 1 off
1050064026	NLGF10QB	250mA	£3.26
1050068684	NLGF17QB	800mA	£0.68
1050063078	NLGF18QB	1	£0.68
1050063080	NLGF22QB	2	£0.68
1050068685	NLGF23QB	2.5	£0.68
1050063081	NLGF24QB	3	£0.68
1050068686	NLGF26QB	4	£0.68
1050063082	NLGF27QB	5	£0.68
1050063084	NLGF31QB	8	£0.68
1050063085	NLGF32QB	10	£0.68
1050063086	NLGF35QB	16	£0.68
1050063087	NLGF36QB	20	£0.68



FUSES - CERAMIC



20mm x 5mm

ORDER CODE	MODEL NO.	TYPE	RATING (Amps)	VOLT.	PRICE - EA 1 off
1050063108	NLCFM13SB	Slow Blow	500mA	250V	£1.60
1050063099	NLCFM18QB	Quick Blow	1	250V	£1.34
1050066460	NLCFM627QB	Quick Blow	5	600V	£9.65
1050066461	NLCFM632QB	Quick Blow	10	600V	£10.11



1 1/4" x 1/4"

ORDER CODE	MODEL NO.	TYPE	RATING (Amps)	VOLT.	PRICE - EA 1 off
1050063116	NLCF13QB	Quick Blow	500mA	500V	£1.99
1050066462	NLCF18QB	Quick Blow	1	600V	£2.13
1050066463	NLCF32QB	Quick Blow	10	600V	£2.32
1050066464	NLCF34SB	Slow Blow	15	500V	£1.95



we've got
specials

If you need them, we've got them

If you can't find them,

we'll track them down

If you need a special, we'll find it for you

- simply contact your local branch

All prices subject to VAT at 17.5%.

CONSUMER UNITS & DEVICES

Introduction

The new range of Newlec consumer units are designed to help installers meet the high demands of the modern domestic installation.

The range includes new insulated and metal clad units that are designed for ease of installation with all round cable entries and extra wiring space.

The fantastic product choice includes all of the previous popular models such as the split load units plus some additional models designed especially with the 17th edition wiring regulations in mind, including high integrity and dual RCD boards.

The high integrity range also includes competitively priced units, supplied complete with MCBs.

INSULATED

METAL CLAD



- New modern curved style insulated and metal clad consumer units.
- Additional models for the 17th Edition i.e. high integrity and dual RCD models.
- Extended range of MCBs, RCBOs and RCDs.
- Designed for ease of installation:
 - All round cable entries.
 - Extra wiring space.
 - Raised DIN rail providing top and bottom cable routes.
 - Neutral and Earth terminals all at the top of the enclosure.
 - Full DIN rail allows easy mounting of DIN accessories and devices.
 - Quarter turn screw for quick release of the cover.



DOMESTIC CIRCUIT PROTECTION

DOMESTIC CONSUMER UNITS

MAIN SWITCH INCOMER



- 2, 5, 8 and 11 way.
- 100A main switch incomer (two way is 63A).
- Insulated.

- All circuits can be independently protected by the use of 1 module RCBOs.
- Allows fitting of 1 module RCBO.



ORDER CODE	MODEL NO.	DESCRIPTION	DIMENSIONS (mm)			NUMBER OF WAYS			PRICE - EA
			H	W	D	SWITCH	RCD1	RCD2	
1051009254	NLCU2PSW/N	2 Way Unit C/W 63A Main Switch	225	141	111	2	-	-	£20.84
1051009255	NLCU5PSW/N	5 Way Unit C/W 100A Main Switch	225	194	111	5	-	-	£25.25
1051009256	NLCU8PSW/N	8 Way Unit C/W 100A Main Switch	225	248	111	8	-	-	£29.66
1051009257	NLCU11PSW/N	11 Way Unit C/W 100A Main Switch	225	302	111	11	-	-	£32.97

RCD INCOMER



- 2, 5, 8, and 11 way.
- 80A 30mA RCD main switch incomer (two way is 63A 30mA).

- Insulated.
- Provides 100% RCD protection



ORDER CODE	MODEL NO.	DESCRIPTION	DIMENSIONS (mm)			NUMBER OF WAYS			PRICE - EA
			H	W	D	SWITCH	RCD1	RCD2	
1051009258	NLCU2PRC/N	2 Way Unit C/W 63A 30mA RCD	225	141	111	-	2	-	£44.04
1051009259	NLCU5PRC/N	5 Way Unit C/W 80A 30mA RCD	225	194	111	-	5	-	£49.56
1051009260	NLCU8PRC/N	8 Way Unit C/W 80A 30mA RCD	225	248	111	-	8	-	£60.58
1051009261	NLCU11PRC/N	11 Way Unit C/W 100A 30mA RCD	225	302	111	-	11	-	£71.60

SPLIT LOAD UNITS



- 9, 12 and 17 way.
- 100A main switch.
- 80A 30mA RCD.
- Insulated.
- Flexible configuration.
- Allows for some high integrity/independent circuits.
- Allows fitting of 1 module RCBO.
- All round cable entries.



ORDER CODE	MODEL NO.	DESCRIPTION	DIMENSIONS (mm)			NUMBER OF WAYS			PRICE - EA
			H	W	D	SWITCH	RCD1	RCD2	
1051009264	NLCU9PSL/N	9 Way Unit 100A Main Switch 1 x 80A 30mA RCD	225	302	111	3 to 6	2 to 7	-	£61.18
1051009265	NLCU12PSL/N	12 Way Unit 100A Main Switch 1 x 80A 30mA RCD	225	355	111	4 to 8	4 to 8	-	£65.70
1051009266	NLCU17PSL/N	17 Way Unit 100A Main Switch 1 x 80A 30mA RCD	225	445	111	5 to 12	4 to 13	-	£88.14

All prices subject to VAT at 17.5%.

SHOWER UNIT C/W MCB



- Compact unit.
- Complete with RCD and 50A MCB.
- Insulated.



ORDER CODE	MODEL NO.	DESCRIPTION	DIMENSIONS (mm)			NUMBER OF WAYS			PRICE - EA
			H	W	D	SWITCH	RCD1	RCD2	
1051009262	NLCUSHOWER/N	2 Way Unit c/w 1 x 63A 30mA RCD + 1 x 50A MCB	225	141	111	-	2	-	£46.58

GARAGE UNIT C/W MCB



- Compact unit.
- Complete with RCD, 16A and 6A MCBs.
- Insulated.



ORDER CODE	MODEL NO.	DESCRIPTION	DIMENSIONS (mm)			NUMBER OF WAYS			PRICE - EA
			H	W	D	SWITCH	RCD1	RCD2	
1051009263	NLCUGARAGE/N	2 Way Unit c/w 40A 30mA RCD + 1 x 6A, 1 x 16A MCB	155	110	115	-	2	-	£46.58

HIGH INTEGRITY INSULATED CONSUMER UNITS

HIGH INTEGRITY CONSUMER UNITS (MAIN SWITCH + 2 x RCD)



- 10 and 15 way.
- Variety of configurations for each board size (i.e MS+2, RCD+4, RCD+4).
- 100A main switch.
- 2 x 63A 30mA RCD.
- Insulated.
- Allows for some high integrity/independent circuits.
- Allows fitting of 1 Module RCBO.
- All round cable entries.



ORDER CODE	MODEL NO.	DESCRIPTION	DIMENSIONS (mm)			NUMBER OF WAYS			PRICE - EA
			H	W	D	SWITCH	RCD1	RCD2	
1051009274	NLCUIH244/N	10 Way Unit Insulated 100A Main Switch, 2 x 63A 30mA RCD	225	355	111	2	4	4	£165.31
1051009275	NLCUIH433/N	10 Way Unit Insulated 100A Main Switch, 2 x 63A 30mA RCD	225	355	111	4	3	3	£165.31
1051009276	NLCUIH465/N	15 Way Unit Insulated 100A Main Switch, 2 x 63A 30mA RCD	225	445	111	4	6	5	£187.36

DUAL RCD CONSUMER UNIT (MAINS SWITCH + 2 x RCD)



- 10 and 15 way.
- 5+5 or 8+7 split.
- 100A main switch.
- 1 x 63A 30mA RCD, and 1 x 80mA 30mA RCD.
- Insulated.
- All round cable entries.



ORDER CODE	MODEL NO.	DESCRIPTION	DIMENSIONS (mm)			NUMBER OF WAYS			PRICE - EA
			H	W	D	SWITCH	RCD1	RCD2	
1051009277	NLCU55DRC/N	10 Way Unit Insulated 100A Main Switch, 1 x 63A 30mA RCD, 1 x 80A 30mA RCD	225	335	111	-	5	5	£163.10
1051009278	NLCU87DRC/N	15 Way Unit Insulated 100A Main Switch, 1 x 63A 30mA RCD, 1 x 80A 30mA RCD	225	445	111	-	8	7	£174.13

All prices subject to VAT at 17.5%.

DOMESTIC CIRCUIT PROTECTION

HIGH INTEGRITY INSULATED CONSUMER UNITS - COMPLETE PACKAGES

SPLIT LOAD CONSUMER UNITS (MAINS SWITCH + 2 x RCD + MCB)



- 10 and 15 way.
- 100A main switch.
- 2 x 63A 30mA RCD.
- Boards come complete with MCBs.
- Variety of configurations for each board size.
- Insulated.
- Can provide 100% RCD protection.
- Allows for some high integrity/independent circuits.
- Allows fitting of 1 module RCBO.
- Space for additional MCB or RCBO of choice.



ORDER CODE	MODEL NO.	DESCRIPTION	DIMENSIONS (mm)			NUMBER OF WAYS			PRICE - EA
			H	W	D	SWITCH	RCD1	RCD2	
1051009279	NLCUHI244MCB/N	10 Way Unit Insulated 100A Main Switch, 2 x 30mA RCD c/w 1 x 50A, 3 x 32A, 1 x 16A, 2 x 6A MCB, 3 x Blanks	225	355	111	2	4	4	£190.27
1051009280	NLCUHI465MCB/N	15 Way Unit Insulated 100A Main Switch, 2 x 30mA RCD c/w 1 x 50A, 3 x 32A, 2 x 16A, 3 x 6A MCB, 6 x Blanks	225	445	111	4	6	5	£220.43

METAL CONSUMER UNITS

MAIN SWITCH INCOMER



- 2, 5, 8 and 11 way.
- 100A main switch incomer (2 way 63A).
- Full metal casing.
- Larger enclosure to allow more wiring space.
- Knockouts for all round cable entries.
- Raised DIN Rail allowing for wiring path beneath DIN Rail.
- Can provide 100% RCD protection by using RCBOs.



ORDER CODE	MODEL NO.	DESCRIPTION	DIMENSIONS (mm)			NUMBER OF WAYS			PRICE - EA
			H	W	D	SWITCH	RCD1	RCD2	
1051009267	NLCU2MSW/N	2 Way Unit Metal Surface Mount 63A Main Switch	210	126	96	2	-	-	£30.81
1051009268	NLCU5MSW/N	5 Way Unit Metal Surface Mount 100A Main Switch	238	188	123	5	-	-	£41.45
1051009269	NLCU8MSW/N	8 Way Unit Metal Surface Mount 100A Main Switch	238	241	123	8	-	-	£43.12
1051009270	NLCU11MSW/N	11 Way Unit Metal Surface Mount 100A Main Switch	238	292	123	11	-	-	£44.04

RCD INCOMER



- 2, 5 and 8 way.
- 80A 30mA RCD main switch incomer (2 way 63A 30mA).
- Full metal casing.
- Larger enclosure to allow more wiring space.
- Knockouts for all round cable entries.
- Raised DIN Rail allowing for wiring path beneath DIN Rail.
- Provides 100% RCD protection.



ORDER CODE	MODEL NO.	DESCRIPTION	DIMENSIONS (mm)			NUMBER OF WAYS			PRICE - EA
			H	W	D	SWITCH	RCD1	RCD2	
1051009271	NLCU2MRC/N	2 Way Unit Metal Surface Mount 63A 30mA RCD	210	126	96	-	2	-	£60.58
1051009272	NLCU5MRC/N	5 Way Unit Metal Surface Mount 80A 30mA RCD	238	188	123	-	5	-	£66.09
1051009273	NLCU8MRC/N	8 Way Unit Metal Surface Mount 80A 30mA RCD	238	241	123	-	8	-	£77.12

All prices subject to VAT at 17.5%.

SINGLE POLE RCBOs



- Classification type C, 6kA.
- Single pole RCBOs.
- 18mm wide - single DIN module.
- 30mA trip sensitivity.
- Ideal for personal protection.
- Manufactured and approved to BS EN 61009.



ORDER CODE	MODEL NO.	DESCRIPTION	PRICE - EA	
			1 off	5 off
1050152758	NLRCB630A	6A 30mA RCBO	£56.39	£51.26
1051009245	NLRCB1030A	10A 30mA RCBO	£56.39	£51.26
1050152759	NLRCB1630A	16A 30mA RCBO	£56.39	£51.26
1051009246	NLRCB2030A	20A 30mA RCBO	£56.39	£51.26
1050152760	NLRCB3230A	32A 30mA RCBO	£56.39	£51.26
1051009247	NLRCB4030A	40A 30mA RCBO	£56.39	£51.26

* Type B 6kA RCBO available.

DOUBLE POLE RCBOs



- Classification type C, 6kA.
- 30mA trip sensitivity.
- Manufactured and approved to BS EN 61009.
- Ideal for personal protection.
- Double pole.



ORDER CODE	MODEL NO.	DESCRIPTION	PRICE - EA	
			1 off	5 off
1051009248	NLRCB630A/2	6A 30mA RCBO	£55.07	
1051009249	NLRCB1030A/2	10A 30mA RCBO	£55.07	
1051009250	NLRCB1630A/2	16A 30mA RCBO	£55.07	
1051009251	NLRCB2030A/2	20A 30mA RCBO	£55.07	
1051009252	NLRCB3230A/2	32A 30mA RCBO	£55.07	
1051009253	NLRCB4030A/2	40A 30mA RCBO	£55.07	

SINGLE POLE MCBs



- 6kA rating.
- DIN rail mounting.
- Ratings from 6A to 50A.
- Moulding provides shroud for busbar.
- Manufactured and approved to BS EN 60898.



ORDER CODE	MODEL NO.	DESCRIPTION	PRICE - EA	
			1 off	10 off
1050152751	NLMB106	6A MCB SP TYPE-B	£6.00	£5.46
1050344100	NLMCI06	6A MCB SP TYPE-C	£6.00	£5.46
1050152752	NLMB110	10A MCB SP TYPE-B	£6.00	£5.46
1050152753	NLMB116	16A MCB SP TYPE-B	£6.00	£5.46
1050152754	NLMB120	20A MCB SP TYPE-B	£6.00	£5.46
1050152755	NLMB132	32A MCB SP TYPE-B	£6.00	£5.46
1050152756	NLMB140	40A MCB SP TYPE-B	£6.00	£5.46
1050152757	NLMB150	50A MCB SP TYPE-B	£6.00	£5.46
1050150556	NLCUB	Blank Cover 1 Module	£0.50	-

DOUBLE POLE RCDs



- Electromechanical tripping mechanism.
- DIN rail mounting.
- Accepts cable wiring up to 25mm² max.
- 230V AC.
- Manufactured and approved to BS EN 61008.



ORDER CODE	MODEL NO.	DESCRIPTION	PRICE - EA	
			1 off	5 off
1050152761	NLRCD1630A	16A 30mA RCD	£51.05	£46.41
1050150562	NLRCD2530A	25A 30mA RCD	£51.05	£46.41
1050150563	NLRCD4030A	40A 30mA RCD	£51.16	£46.55
1050150564	NLRCD6330A	63A 30mA RCD	£61.90	£56.28
1050150565	NLRCD8030A	80A 30mA RCD	£71.80	£65.27
1050152762	NLRCD10030A	100A 30mA RCD	£79.54	£72.31
1050152763	NLRCD80100A	80A 100mA RCD	£68.92	£62.66
1050152764	NLRCD100100A	100A 100mA RCD	£75.43	£68.57

All prices subject to VAT at 17.5%.

RCD ENCLOSURES/ISOLATOR SWITCHES

DOUBLE POLE MAIN SWITCH



- Double pole 230V 50Hz.
- Category of duty: AC21.
- Shrouded terminals.
- Positive contact position indication.
- Manufactured and approved to BS EN 60947-3.

CE

ORDER CODE	MODEL NO.	DESCRIPTION	PRICE - EA
			1 off
1050151003	NLCUSW100	100A Main Switch	£10.97

RCD ENCLOSURES



- Complete with mounting rail.
- Metal version with earth stud.

CE

ORDER CODE	MODEL NO.	DESCRIPTION	PRICE - EA
			1 off
1000008702	NLRCDEPA	2 Module Insulated IP40	£5.46
1000008703	NLRCDESA	3 Module Steel IP40	£16.48
1050151005	NLRCDEWA	3 Module Insulated c/w Hinged Cover IP65	£14.28

METAL ENCLOSED ISOLATOR



- Double pole 230V 50Hz.
- Category of duty: AC21.
- Shrouded terminals.
- Positive contact position indication.
- Manufactured and approved to BS EN 60947-3.

CE



ORDER CODE	MODEL NO.	DESCRIPTION	PRICE - EA
			1 off
1050151004	NLSW32T	32A TPN Surface SW Metal	£23.79

All prices subject to VAT at 17.5%.

TIMERS - SINGLE/TWO CHANNEL

	SINGLE CHANNEL ANALOGUE - 24 HR	SINGLE CHANNEL DIGITAL - 24 hr 7 day	TWO CHANNEL DIGITAL - 24 hr 7 day
ORDER CODE	1050152769	1050152767	1050152768
MODEL NO.	NLCUT3	NLCUT1	NLCUT2
NUMBER OF MODULES	1	1	2
POWER CONSUMPTION	5VA	5VA	5VA
RESISTIVE LOAD	16A	16A	16A
INDUCTIVE LOAD	2.5A	2.5A	10A
SWITCHING CONTACTS	1 x N/0	1 x C/0	2 x C/0
AMBIENT TEMPERATURE	-25°C to +55°C	-10°C to +50°C	-10°C to +50°C
ACCURACY	Typ 2.5s Per Day	Typ 2.5s Per Day	Typ 1s Per Day
RUNNING RESERVE	N/A	150h at +20°C	250h at +20°C
SHORTEST SWITCHING TIME	30 Minutes	1 Minute	1 Minute
PROGRAMMABLE DURATION	Every 30 Minutes	Every Minute	Every Minute
HOLIDAY PROGRAM	N/A	Max 99 Days	Max 47 Days
MANUAL OVERRIDE	N/A	Yes	Yes
SUMMER/WINTER SWITCH OVER	N/A	Yes (Manual)	Yes (Manual)
SEALABLE	No	Yes	No
INSTALLABLE IN CONSUMER UNIT	Yes	Yes	Yes
CE	CE	CE	CE
PRICE EA - 1 off	£3710	£73.81	£95.86



NLCUBT

NLCUT1

NLCUT2

NLCUT3

NLCUC1



BELL TRANSFORMER

- Two module.
- DIN mounting bell transformer.
- Can be installed integral to consumer unit.

- Discreet installation.
- 12V 8VA.



ORDER CODE	MODEL NO.	PRICE - EA
		1 off
1050152765	NLCUBT	£17.59

CONTACTOR - 20A DOUBLE POLE

- Single module.
- DIN rail mounting contactor.
- Double pole 20A.

- Can be installed integral to consumer unit.
- 230V 50Hz - AC1 AC7a.



ORDER CODE	MODEL NO.	PRICE - EA
		1 off
1050152766	NLCUC1	£23.10

All prices subject to VAT at 17.5%.